

LEASING PLAN NOTES

- 1 GROSS LEASABLE AREA IS MEASURED TO OUTSIDE OF EXTERIOR WALLS AND TO CENTER OF WALLS BETWEEN TENANT SPACES PER BOMA STANDARDS.
- 2 SIZES SHOWN FOR ROOMS AND SPACES ARE APPROXIMATE.

LEASABLE AREA			
SUITE #	FIRST FLOOR	MEZZANINE	TOTAL
SUITE 1	8637 SQ FT	N/A	8637 SQ FT
SUITE 2	4261 SQ FT	N/A	4261 SQ FT
SUITE 3A	2156 SQ FT	N/A	2156 SQ FT
SUITE 3B	2317 SQ FT	N/A	2317 SQ FT
SUITE 4	19990 SQ FT	6455 SQ FT	26445 SQ FT

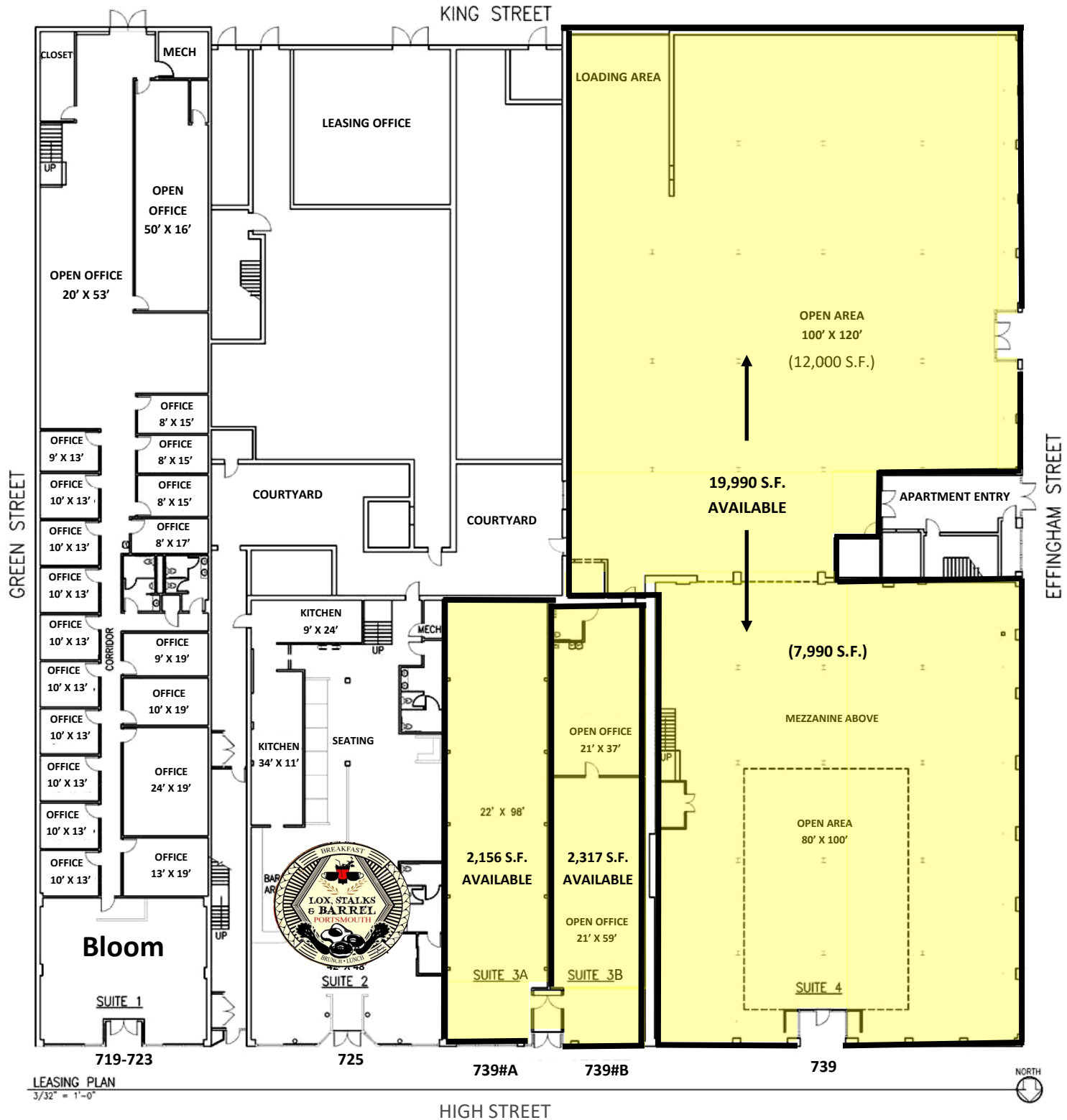

Montgomery Square Shoppes
719-739 High Street
Portsmouth, VA 23704

LEASING PLAN
 3/32" = 1'-0"

HIGH STREET

